

PROPOSED LAY-OUT MAP OF

"SHRI JAGANNATH SAROVER"

AT VILLAGE :-DHANI CHOUDHRIYON WALLI,TEH:- KHANDELA,SIKAR.

KHASARA NO:- 1461/2,1468.

SCALE :- 1" =50' FEET

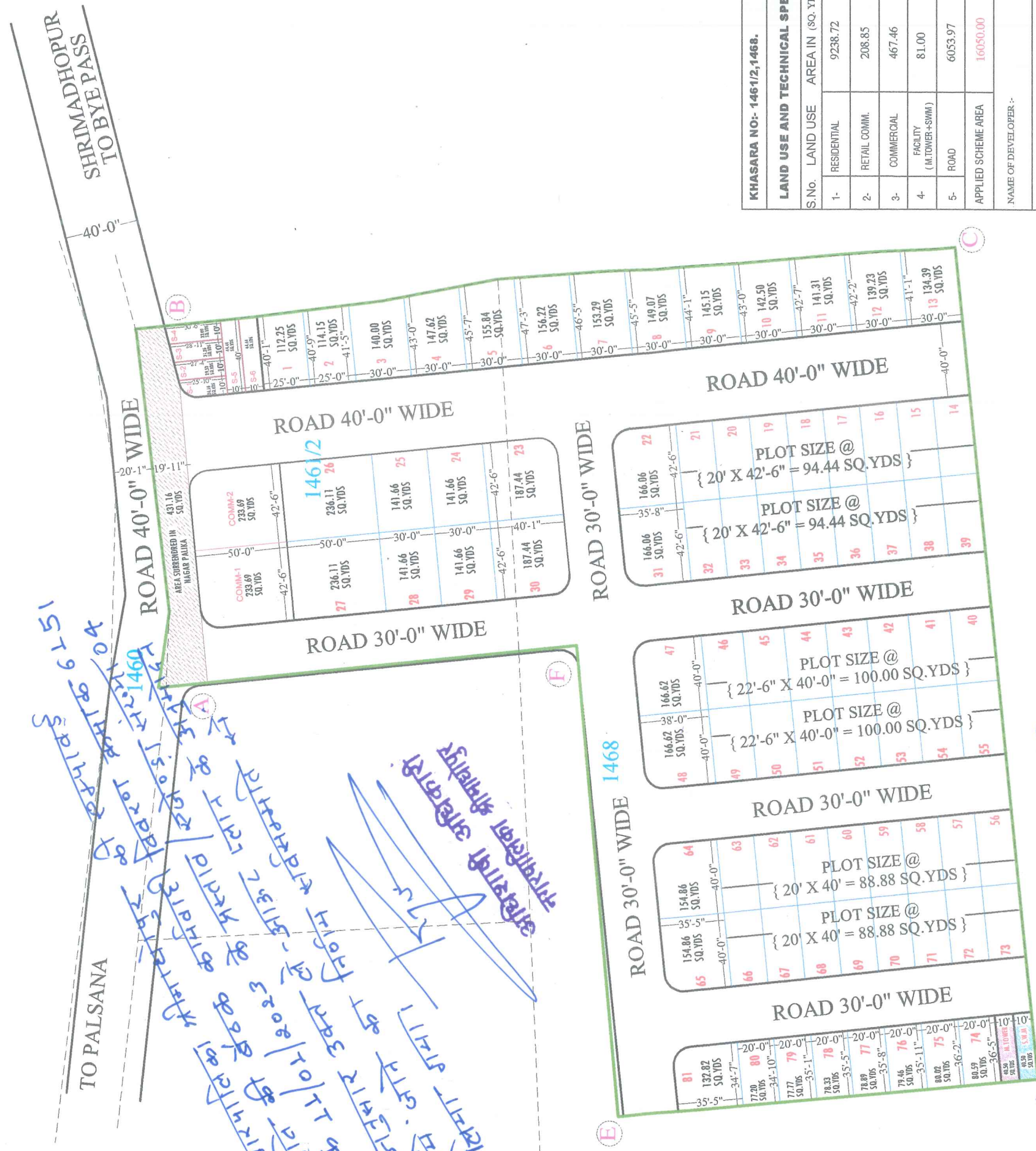
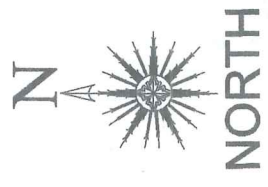

**KHASARA NO:- 1461/2,1468.**

LAND USE AND TECHNICAL SPECIFICATIONS			
S.No.	LAND USE	AREA IN (SQ. YDS.)	PERCENTAGE
1-	RESIDENTIAL	9238.72	57.56%
2-	RETAIL COMM.	208.85	1.30%
3-	COMMERCIAL	467.46	2.91%
4-	FACILITY (M.TOWER+SMM)	81.00	0.50%
5-	ROAD	6053.97	37.73%
APPLIED SCHEME AREA		16050.00	100.00%

NAME OF DEVELOPER :-  
 NAME OF SCHEME :- SHRI JAGANNATH SAROVER \*  
 NORTH: SCALE : 1" = 50' Feet  
 DRAWING TITLE: PROPOSED LAYOUT PLAN FOR  
 PROJECT: SHRI JAGANNATH SAROVER \*  
 DEVELOPERS:

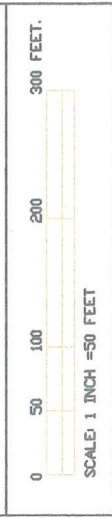

**Tricad consultancy**  
 A Complete Design Studio  
 15202, SHIPRA PATH NEAR PATEL MARG TIRAHA, MANSAROVER, JAIPUR  
 E-mail:- Tricad2019@gmail.com  
 MOBILE:- 9794970855, 7737246189

SUBMITTED TO:- NAGAR PALIKA SHRIMADHOPUR

उक्त प्लान-आकट प्लान कमालाम बिला नगर नियोजक नगर निमोजन विभागा, सीकर के पत्रांक सीपीएसके.1600/श्रीमाद्योपुर/2022/1465 दिनांक 19/12/2022 का संलग्न है।

Lokesh Mishra  
 कनिष्ठ अभियन्ता  
 नगरपालिका, श्रीमाद्योपुर

मो. अजहर जादू  
 जिला नगर नियोजक  
 सीकर

