



# Resettlement Plan

---

Project Number: 42267-026  
February 2020  
(Addendum)

## IND: Rajasthan Urban Sector Development Program

Subproject : Bhilwara Sewerage Subproject.

Submitted by

Rajasthan Urban Infrastructure Development Project, Jaipur

This Addendum to resettlement plan is a document of the borrower. This is an addendum to the resettlement plan posted in August 2019 on <https://www.adb.org/projects/documents/ind-42267-026-rp-2>, The views expressed herein do not necessarily represent those of ADB's Board of Directors, Management, or staff, and may be preliminary in nature.

In preparing any country program or strategy, financing any project, or by making any designation of or reference to a particular territory or geographic area in this document, the Asian Development Bank does not intend to make any judgments as to the legal or other status of any territory or area.

**Asian Development Bank**



Government of Rajasthan  
Office of Project Director

**Rajasthan Urban Infrastructure Development Project**

AVS Building, Jawahar Circle, JLN Marg, Jaipur - 302017  
Tel No.: 0141-2721966, Fax No.: 0141-2721919,  
Email : mail.ruidp@rajasthan.gov.in/ mailruidp@gmail.com, web site : www.ruidp.gov.in

No. F3 (201) (16)/RUIDP/PMU/PH-III/ADB Social Safeguard/General/2017-18/ Date 16/17/ 2020 25/02/2020

**The Country Director,**  
Indian Resident Mission, ADB,  
4 San Martin Marg, Chanakyapuri,  
New Delhi ([psrivastava@adb.org](mailto:psrivastava@adb.org))

**Sub: Submission of Addendum to Resettlement Plan of Bhilwara Sewerage Subproject for RUIDP Phase III (ADB loan no. 3183-IND) as per ADB's Safeguard Policy Statement 2009.**

Sir,

Please find enclosed herewith the Addendum to Resettlement Plan of Bhilwara Sewerage Sub project under Phase III (ADB loan no. 3183-IND) as per ADB's Safeguard Policy Statement 2009 for approval and further necessary action.

Being a Design Build and Operate (DBO) contract, during the finalization of Service Improvement Plan (SIP), on the basis of technical requirements 02 CRMC building and 01 CCC building has been proposed. Accordingly this Addendum to Resettlement Plan of Bhilwara Sewerage Subproject, to indicate the final components of the project.

A Due diligence has been conducted by PMDSC expert and it has been confirmed that no land acquisition is involved, the land at both places is under the possession of the Bhilwara Municipal Council (BMC) and no-objection certificate (NOC) from the Municipal Council for the construction of CRMCs and CCC is obtained.

This addendum has been prepared to update the scope of work and will be read in conjunction with the RP. Kindly send approval and link of website so that same may be uploaded on RUIDP Website.

**Attachment: As above**

**Chief Engineer  
RUIDP, Jaipur**

No. F3 (201) (16)/RUIDP/PMU/PH-III/ADB Social Safeguard/General/2017-18/ Date 16/17-73 25/02/2020

**Copy to the following for information and necessary action please:-**

1. Social safeguard consultant ADB, INRM New Delhi ([smircha@adb.org](mailto:smircha@adb.org))
2. Pradeep Kumar Pandey, Associate Operations Analyst, INRM New Delhi

*Chandra K. Mandawaria*  
25/02/2020  
**(K. M. Mandawaria)**  
**PO (Co-ord. & Social)**



Soft copy recd 26.02.20

**RAJASTHAN URBAN SECTOR DEVELOPMENT PROGRAM  
ASIAN DEVELOPMENT BANK LOAN ASSISTANCE  
(LOAN NO. 3183 IND)**

**Addendum to Resettlement Plan of Bhilwara  
Sewerage Subproject.**

**February 2020**



## **Table of Contents**

I. Introduction .....	1
II. Purpose for Addendum to Resettlement Plan.....	1
III. Social Impact Assessment and Due Diligence.....	1
IV. Stakeholder Consultation .....	3
V. Conclusion .....	3
Appendix 1: Noc of Bhilwara Municipal Council for proposed CRMC and CCC centre .....	4
Appendix 2: Approved Layout Plan for CRMC and CCC in Dadawari .....	5
Appendix 2(a) : Approved Layout Plan for CRMC in Subhash Nagar .....	7
Appendix 3: Photographs of proposed CRMC and CCC, Dadawari .....	9
Appendix 4: Google Map of Proposed CRMC and CCC site, Dadawari .....	11
Appendix 4(a): Google Map of Proposed CRMC Subhash Nagar .....	12
Appendix 5: Stakeholder Consultation .....	13



## ABBREVIATIONS

ADB	–	Asian Development Bank
AE	–	Assistant Engineer
AP	–	Affected Person
ASO	–	Assistant Safeguards Officer
CRMC	-	Consumer Relation Management Center
CCC	-	Central control center
DBO	-	Design-Build and Operate
DPR	–	Detailed Project Report
EA	–	Executing Agency
ER	-	Employer Representative
GOI	–	Government of India
GOR	–	Government of Rajasthan
IA	–	Implementing Agency
PIU	–	Project Implementation Unit
PMU	–	Project Management Unit
LSGD	–	Local Self Government Department
ml/d or MLD	–	Million Liters per day
NGO	–	Non-governmental Organization
PO	–	Project Officer
PMDSC	–	Project Management Design and Supervision Consultant
RF	–	Resettlement Framework
RoW	–	Right of Way
RUIDP	–	Rajasthan Urban Infrastructure Development Project
RUSDP	–	Rajasthan Urban Sector Development Program
SIP	–	Service Improvement Plan
SDP	–	Sector Development Program
SPS	–	Safeguard Policy Statement, 2009
SwPS		Sewer Pumping Station
STP	–	Sewage Treatment Plant
ULB	–	Urban Local Body





## I. Introduction

1. The Bhilwara sewerage scheme is one of the subprojects identified under the Rajasthan Urban Sector Development Program (RUSDP). The original resettlement plan was prepared in September 2014 and later revised in August 2019. The subproject scope included: (i) Construction of one Sewage Treatment Plant (STP) based on Sequencing Batch Reactor (SBR) technology with primary settling tank and gas generation plant of 30 million liters per day (MLD) for part of Zone A & B; (ii) Construction of one Sewage Pumping Station (SwPS) for zone A & B of 48 million liters per day (MLD); (iii) Sewer network- 375 km of dia 176 to 1800 mm; and (iv) Instrumentation, automation and SCADA system in proposed STP and SwPS.

## II. Purpose for Addendum to Resettlement Plan

2. The addendum has been prepared due to the inclusion of the additional scope of construction of the Central Control Center (CCC) and two Consumer Relation Management Centers (CRMC). The revised scope is provided in Table 1.

**Table 1: Details of Works**

S. N.	Name of the Components	Remarks
<b>Scope of work as mentioned in approved RP</b>		
1	Construction of Sewerage Treatment Plant of 30 MLD based on Sequencing Batch Reactor (SBR) technology	No changes.
2	Construction of one Sewage Pumping Station (SwPS) for zone A & B of 48 million liters per day (MLD);	No changes.
3	Property Connection with Sewerage System-45000 nos	No changes in the figure will be finalized after SIP <sup>1</sup> .
4	Sewer network- 375 km of dia 176 to 1800 mm; and	Total length is 410 km(as per BoQ) instead of 375 km, and errors occurred in the approved RP. The exact length will be finalized during SIP, which is under progress.
5	Instrumentation, automation and SCADA system	No changes
<b>Additional Work</b>		
1	Consumer Relation Management Center (CRMC)- 2 Nos and Central Control Center -1 Nos	The CRMC and CCC are proposed on the campus of Ayurvedic hospital in Dadawari, while the second CRMC is proposed on the premises of Community Hall, Subhash Nagar.

## III. Social Impact Assessment and Due Diligence

3. The construction of one CRMC and CCC building is proposed within the campus of Ayurvedic Hospital in the Dadawari area, while the second CRMC is proposed within the premises of Community Hall at Subhash Nagar. The land at both places is under the possession of the Bhilwara Municipal Council (BMC). The RUSDP has obtained the no-objection certificate (NOC) from the Municipal Council for the construction of CRMCs and CCC.

<sup>1</sup>Reassessment of works that to be executed as per technical specification i.e. SIP is a part of contract.

**Table 2: Details of land availability, ownership, and status of land**

Project Component	Location	Ownership	Area of government land available at the location (in sqm)	Area required (in sqm)
CRMC and CCC	Ayurvedic Hospital campus premises in Dadawari area	Bhilwara Municipal Council	2000	150 m <sup>2</sup>
CRMC	In the premises of Community Hall, Subhash Nagar	Bhilwara Municipal Council	732.97	60 m <sup>2</sup>

4. A due diligence visit was undertaken to both the sites (where CRMCs and CCC is proposed to be constructed with the objective to (i) assess whether the subproject causes any resettlement (temporary/permanent, partial/full) impacts on structures and livelihood of titled or non-titled affected persons (APs); (ii) collect evidence (documents, photographs,) to understand/ identify resettlement impacts if any; and (iii) organize the public consultation along the project sites to discuss the resettlement impacts.

5. The field visits (conducted by a team including Nodal Officer PIU, R&R Expert of PMDSC staff of urban local body, Project Contractor and safeguard staff of PMDSC) revealed that vacant land is available in the Ayurvedic Hospital campus premises at Dadawari and within the premises of Community Hall, Subhash Nagar and is in possession of BMC. The RUS DIP has obtained the NOC from BMC for the construction of CRMC and CCC and has been attached as appendix 1 to 4. The photographs of sites are provided in Figure 1.

**Figure 1: Proposed CRMC and CCC site**

6. During impact assessment, it was observed that there is an abandoned structure within the Ayurvedic Hospital campus at Dadawari. The PIU confirmed that the abandoned structure would also be utilized for the construction of CRMC and CCC. The photographs of the abandoned structure are provided in Figure 2.

**Figure 2: Photo of Abandoned structure in the proposed site, Dadawari**



**Abandoned structure in the proposed site, Dadawari**

#### **IV. Stakeholder Consultation**

7. The PMDSC team undertook the necessary consultations with the nearby habitation, and it was confirmed that land at both locations is under the possession of BMC. The consultation also revealed that the Ayurvedic Hospital is not in use for the last 6 to 7 years. During the consultation, the objective of CRMC and CCC was discussed in detail. The local public assured support to the department during construction. The local public near Subhash Nagar also confirmed that BMC had constructed a community hall that is of great help to the public and appreciated the concept of the consumer relationship center. The photographs along with the signature sheet, is provided in **Appendix 5**.

#### **V. Conclusion**

8. As per documentation collected and due diligence visit, there is no land acquisition due to subproject and construction of CRMCs and CCC will not involve any permanent or temporary/ partial or full resettlement on the titled or non-titled people. There will be no impact on the livelihood of titled or non-titled vendors in these areas. The sites are well demarcated and the civil works are proposed to be undertaken within the existing campuses of Ayurvedic Hospital and Community Hall.

**Appendix 1: NOC of Bhilwara Municipal Council for proposed CRMC and CCC centre**

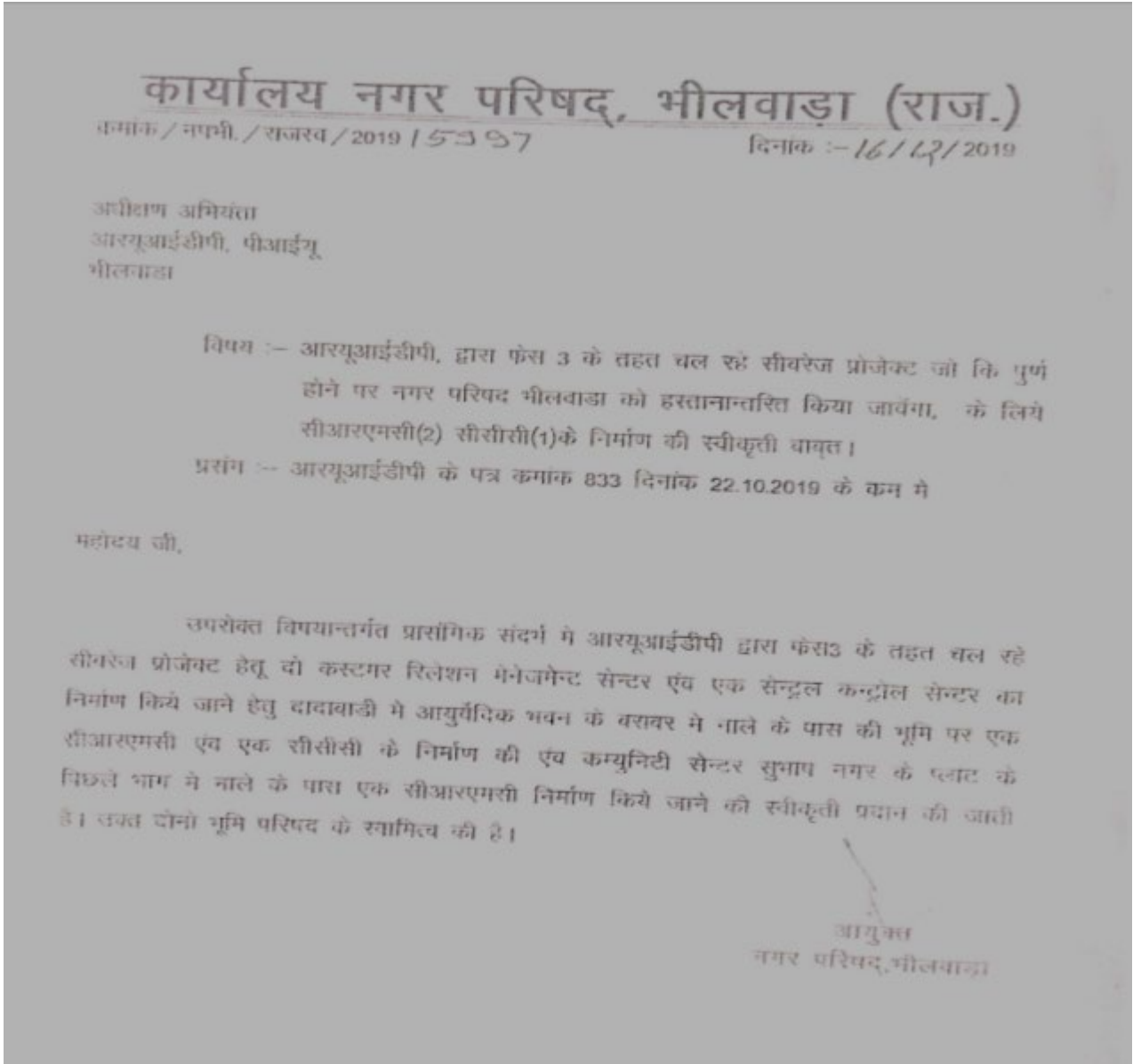

**Transcript**

To, SE, PIU, RUIDP Bhilwara

Sub: **NoC for construction of Consumer Relation Management Centre (CRMC) and Central control center**

Ref: your letter no833 dated 22.10.2019

With the above subject, A permission/ NOC is hereby granted for the construction of Consumer Relation Management Centre (CRMC) and CCC near Ayurvedic Bhawan, Dadawari and in the premises of Community Bhawan, Subhash Nagar

**Commissioner, Municipal Council Bhilwara**

Appendix 2: Approved Layout Plan for CRMC and CCC in Dadawari

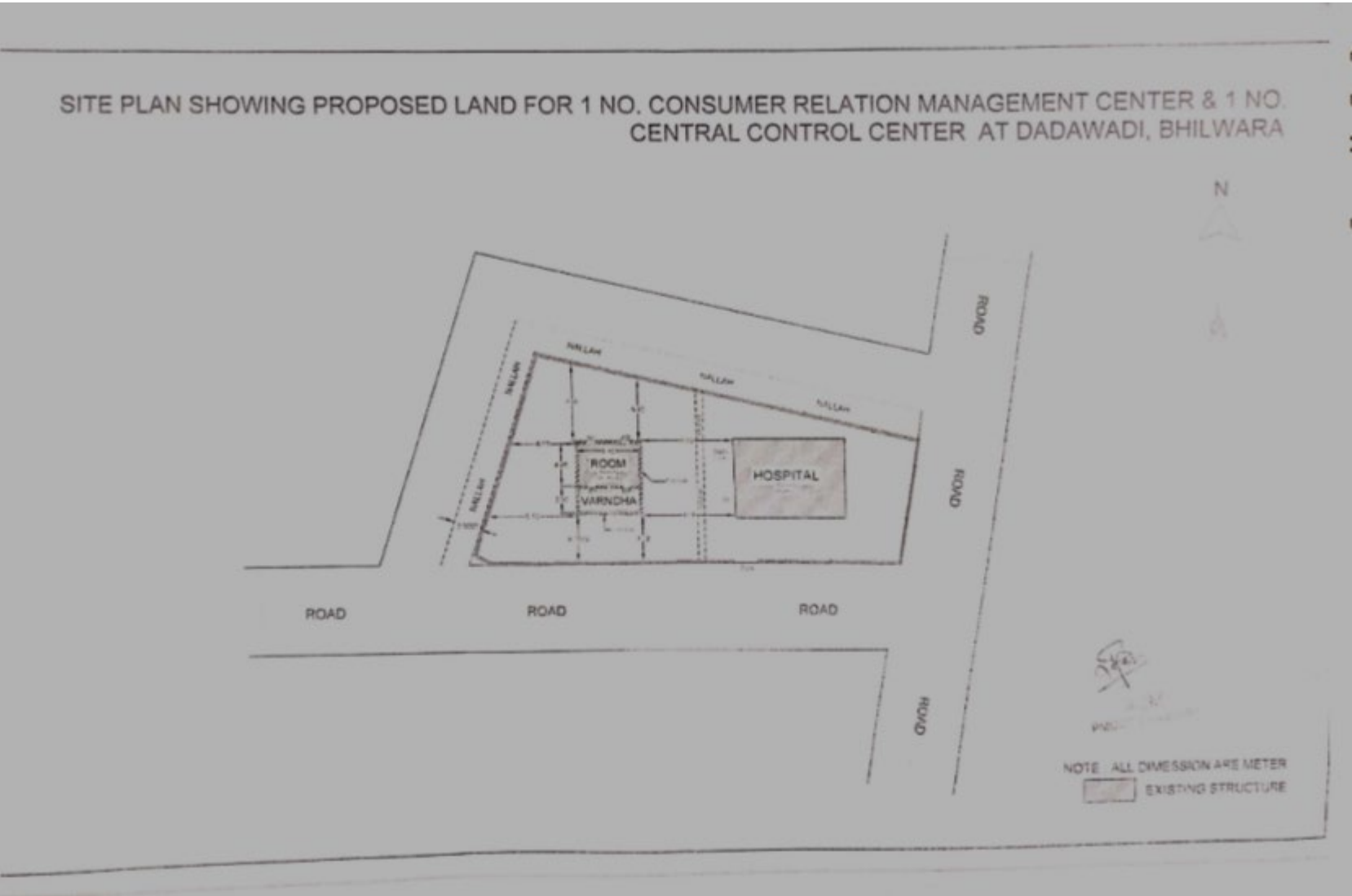

SITE PLAN SHOWING PROPOSED LAND FOR 1 NO. CONSUMER RELATION MANAGEMENT CENTER & 1 NO. CENTRAL CONTROL CENTER AT DADAWADI, BHILWARA



Appendix 2 (a) : Approved Layout Plan for CRMC in Subhash Nagar

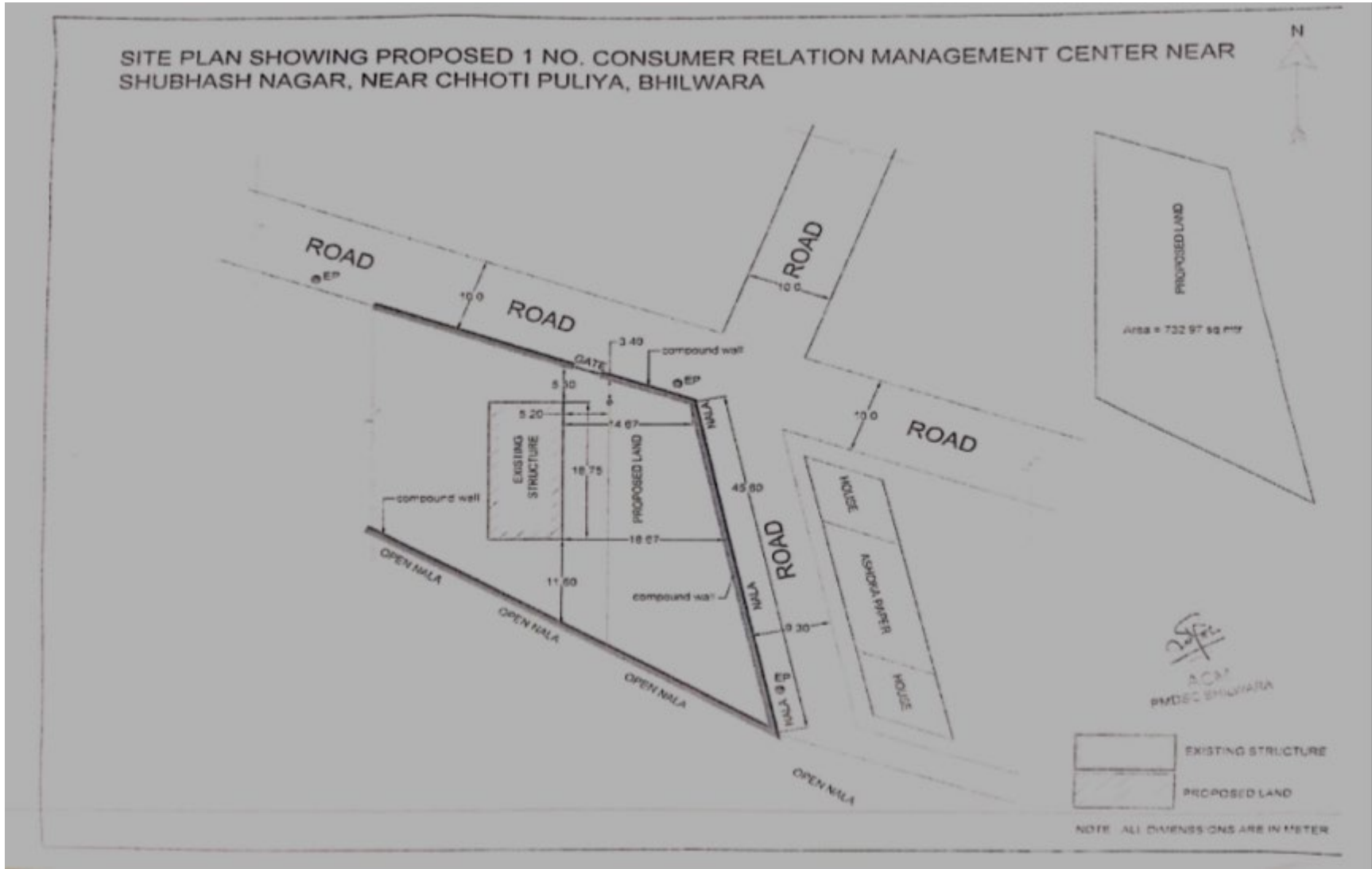

SITE PLAN SHOWING PROPOSED 1 NO. CONSUMER RELATION MANAGEMENT CENTER NEAR SHUBHASH NAGAR, NEAR CHHOTI PULIYA, BHILWARA

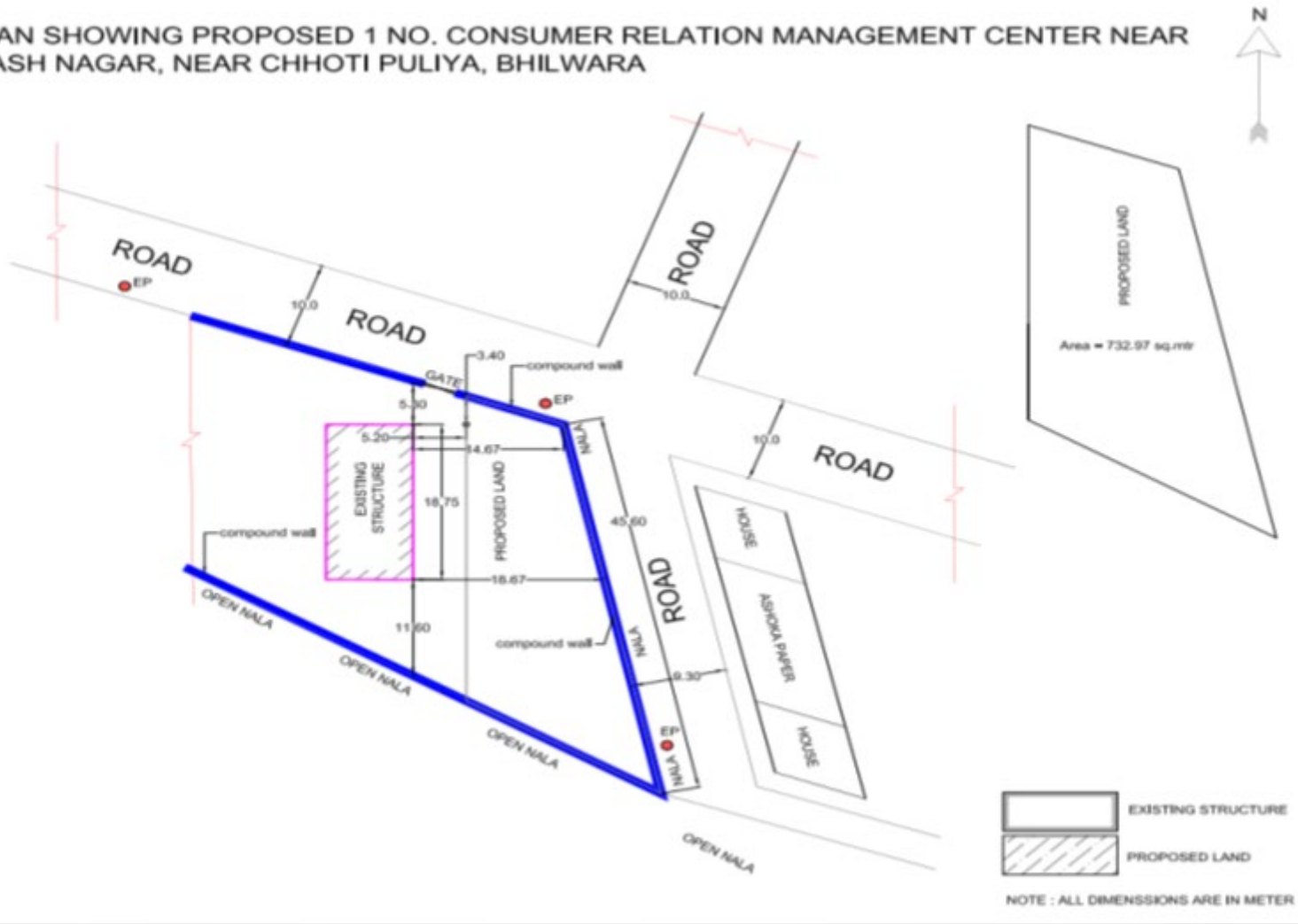



**Appendix 3: Photographs of proposed CRMC and CCC, Dadawari**



**Proposed CRMC and CCC site, Dadawari**



**Ayurvedic Dispensary, which is closed for last 6-7 years**



**Proposed CRMC site in the premises of Community Centre, Subhash Nagar**



**Community Centre of Bhilwara Municipal Council**

**Appendix 4: Google Map of Proposed CRMC and CCC site, Dadawari**

Latitude: 25°20'33.9"N

Longitude: 74°38'56.3"E



**Appendix 4(a): Google Map of Proposed CRMC Subhash Nagar**

Latitude: 25°21'50.5"N

Longitude: 74°38'02.0"E



**Appendix 5: Stakeholder Consultation**



**Consultation near proposed site, Dadawari**



**Consultation near the Proposed site, Subhash Nagar**

## Consultation Sheet

**Rajasthan Urban Sector Development Project  
PMDS-Consultation Sheet**

Place: पुस्तकालय CRML एवं CCL का नया निर्माण के संदर्भ में Date: 23.01.2020  
 Topic: आधुनिक बास्कीट के खरीप पुस्तकालय श्री. धार. रम. की  
एवं श्री. सी. सी. मदन के निर्माण के नए संकेतों से बातची  
तों। लोगों ने बताया कि आधुनिक बास्कीट एवं उभरे हुए  
जो बन रहे 10 साल से बनाई हैं और जोड़ें हैं मैन  
गल परियोजना को है। यदि यदि मदन का निर्माण होगा तो  
स्थानीय लोगों के लिए अच्छा होगा। सभी मैन 'कभी  
गदारी रहती है।

SN	Name	Male / Female	Designation	Mobile/ Phone No.	Signature
	संजय नाथ	M	आस्था/ सामाजिक कार्यकर्ता	9667751400	संजय नाथ
	नंदी लाल	M	आस्था	9928496770	नंदी लाल
	जनीन	M	Education	9166301036	जनीन
	संजय नाथ	M	CAO, PMDS		संजय नाथ
	संजय	M	SO.	9166746898	संजय

J. D. Singh  
 RSR Co-ordinator  
 PMDS

