

PARCEL - D & E P.P.P. MODE MAHALA SCHEME JAIPUR

KEY - PLAN

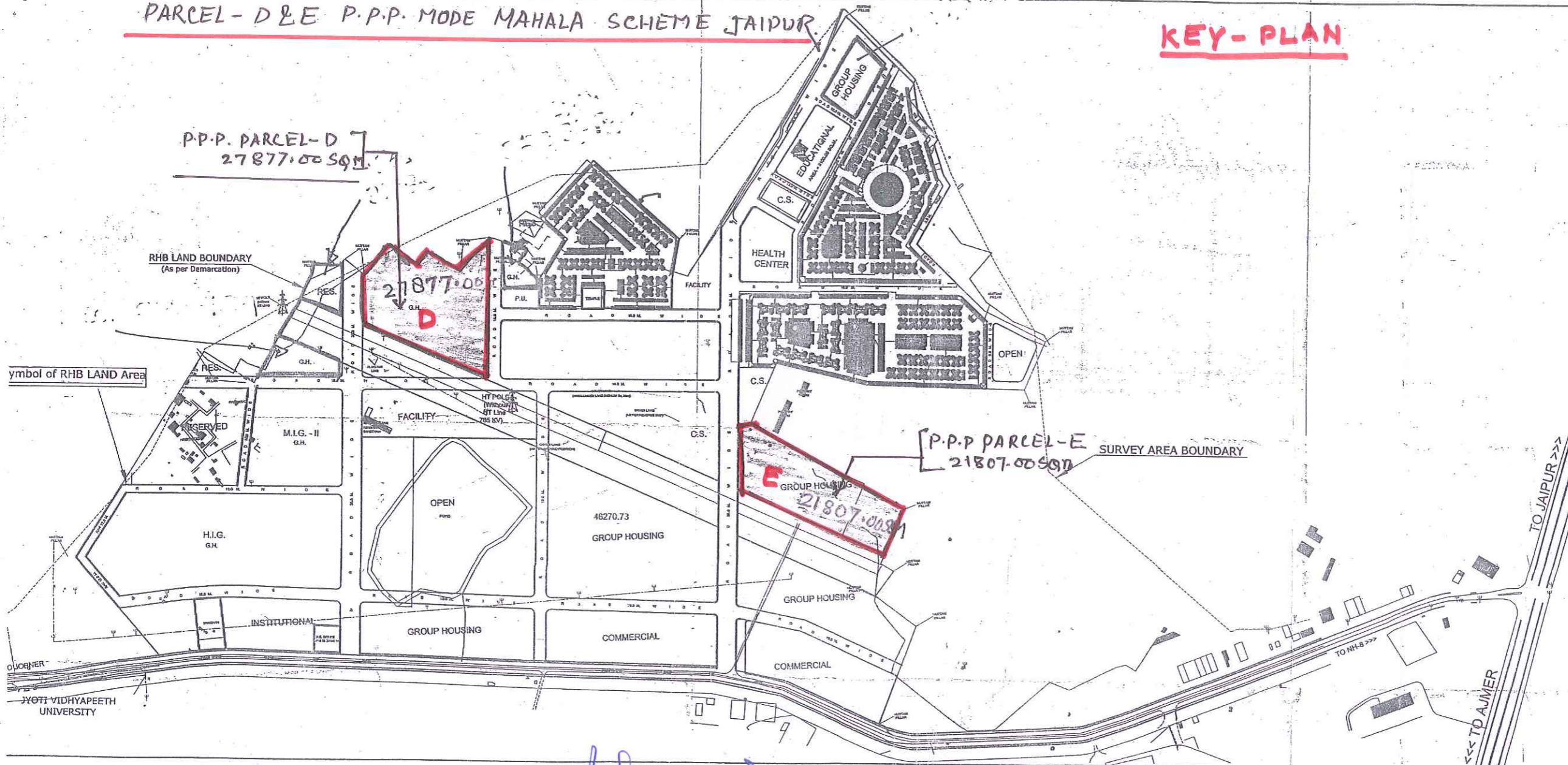

| SCHEDULE OF FLATS | | |
|---|---------------------------------------|-------------|
| BLOCK - A | | |
| LAND AREA = 46888.84 SQ.M. | | |
| S.NO. | TYPE | NO.OF FLATS |
| 1. | M.I.G.II(G+3) | 272 |
| 2. | L.I.G.(G+3) | 464 |
| | | 736 |
| CAR PARKING = 736 | | |
| GROUND COVERAGE = 22.91% | | |
| BLOCK - B | | |
| LAND AREA = 43819.36 SQ.M. | | |
| S.NO. | TYPE | NO.OF FLATS |
| 1. | L.I.G.(G+3) | 400 |
| 2. | E.W.S.(G+3) | 336 |
| | | 736 |
| CAR PARKING = 742 | | |
| GROUND COVERAGE = 16.21% | | |
| BLOCK - C | | |
| LAND AREA = 25340.65 SQ.M. | | |
| S.NO. | TYPE | NO.OF FLATS |
| 1. | L.I.G.(G+3) | 576 |
| CAR PARKING = 576 | | |
| GROUND COVERAGE = 18.47% | | |
| APPROVED IN 146 P.C. MEETING DATED ON - 15-12-2014 AGENDA ITEM NO.- 3 | | |
| REVISED SHOWN THIS :- | | |
| REVISED LAY OUT PLAN OF FLATS MEHLA RESIDENTIAL SCHEME JAIPUR. | | |
| DRG. NO. RHB/HQ/14 | SCALE :- | |
| DATE-15-12-2014 | FILE NO. | |
| DEALT:- R.K.GUPTA | CHECKED:- P.R. SINGHMAR | |
| (M.L.BALODIA) ASST.ARCHITECT | (B.S. RAJPUROHIT) DY. TOWN PLANNER | |
| ADD.CHIEF TOWN PLANNER | (K.C. MEENA) CHIEF ENGINEER - II | |
| RAJSTHAN HOUSING BOARD | | |

ए.एस. हाड़ा
PECS (SR)

एम. एस. हाड़ा
आवासीय अभियंता
खण्ड दशम रा. आ. म.
जयपुर



BLOCK - D
TOTAL LAND AREA = 27877.00 SQ.M.

SET BACKS :-

FRONT-I = 6.00 M
FRONT-II = 6.00 M
SIDE-I = 9.00 M
SIDE-II = 9.00 M

OTHERS NORMS AS PER UNIFIED BUILDING
BYE LAWS 2017

APPROVED IN 153rd P.C. MEETING DATED
8-2-2018 AGENDA NO. 8



PROPOSED PART PLAN OF GROUP HOUSING
BLOCK - D (P.P.P. MODE) MAHLA RESIDENTIAL
SCHEME JAIPUR.

| | |
|--------------------|-----------------|
| DRG. NO RHR/HQ/18/ | SCALE :- |
| DATE-26-2-2018 | FILE NO. |
| DEALT :- R.K.GUPTA | CHD :- SUKHODEV |

| | |
|--|--|
| (P. C. YADAV) ASISTANT TOWN PLANNER | (B.S. RAJURSHIT) DEPUTY TOWN PLANNER |
| (JHRNALL JOSHI) SENIOR TOWN PLANNER | (S. L. SETHI) ADD. CHIEF TOWN PLANNER |

RAJASTHAN HOUSING BOARD

RAJASTHAN HOUSING BOARD

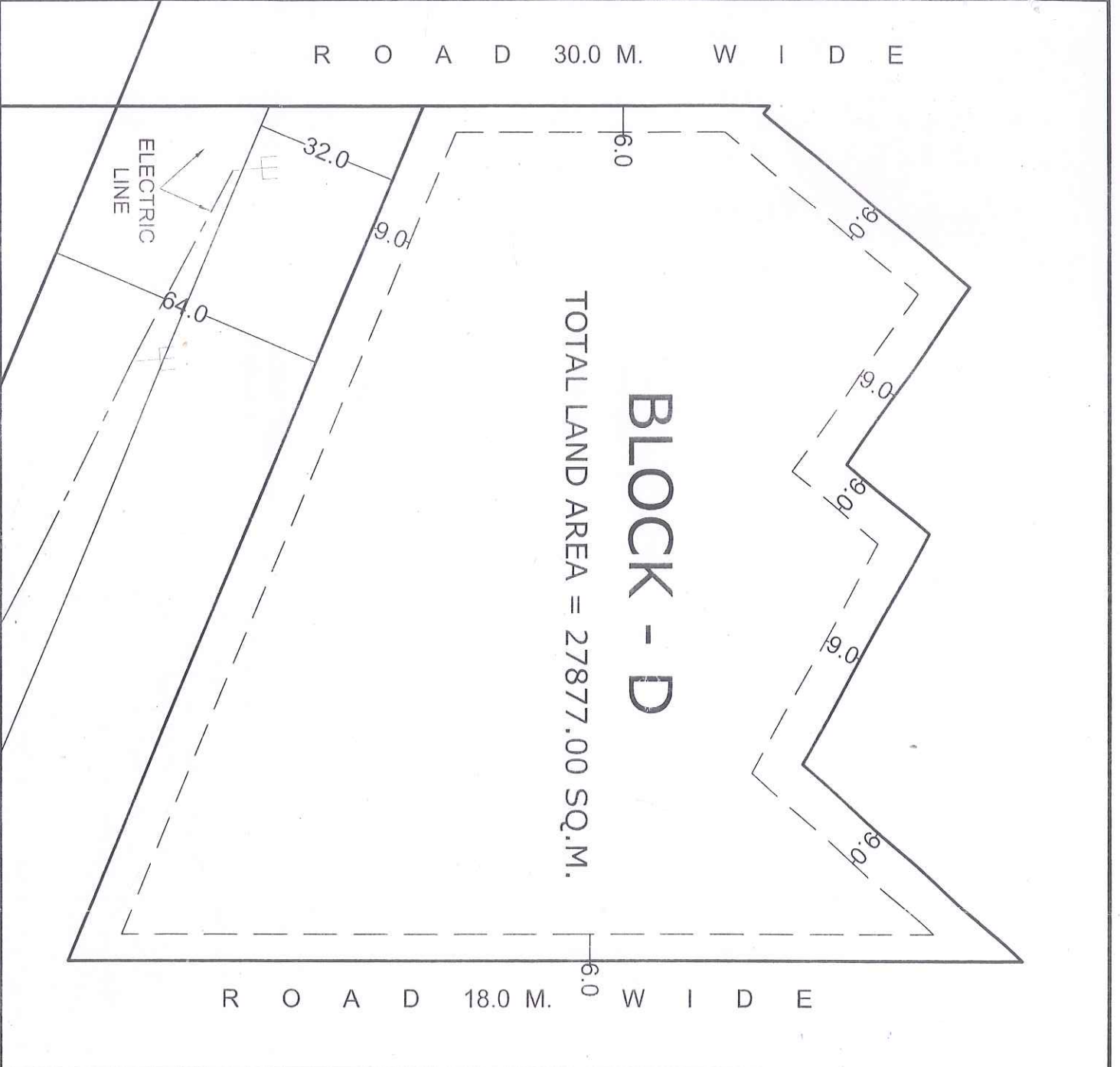

R O A D 30.0 M. W I D E

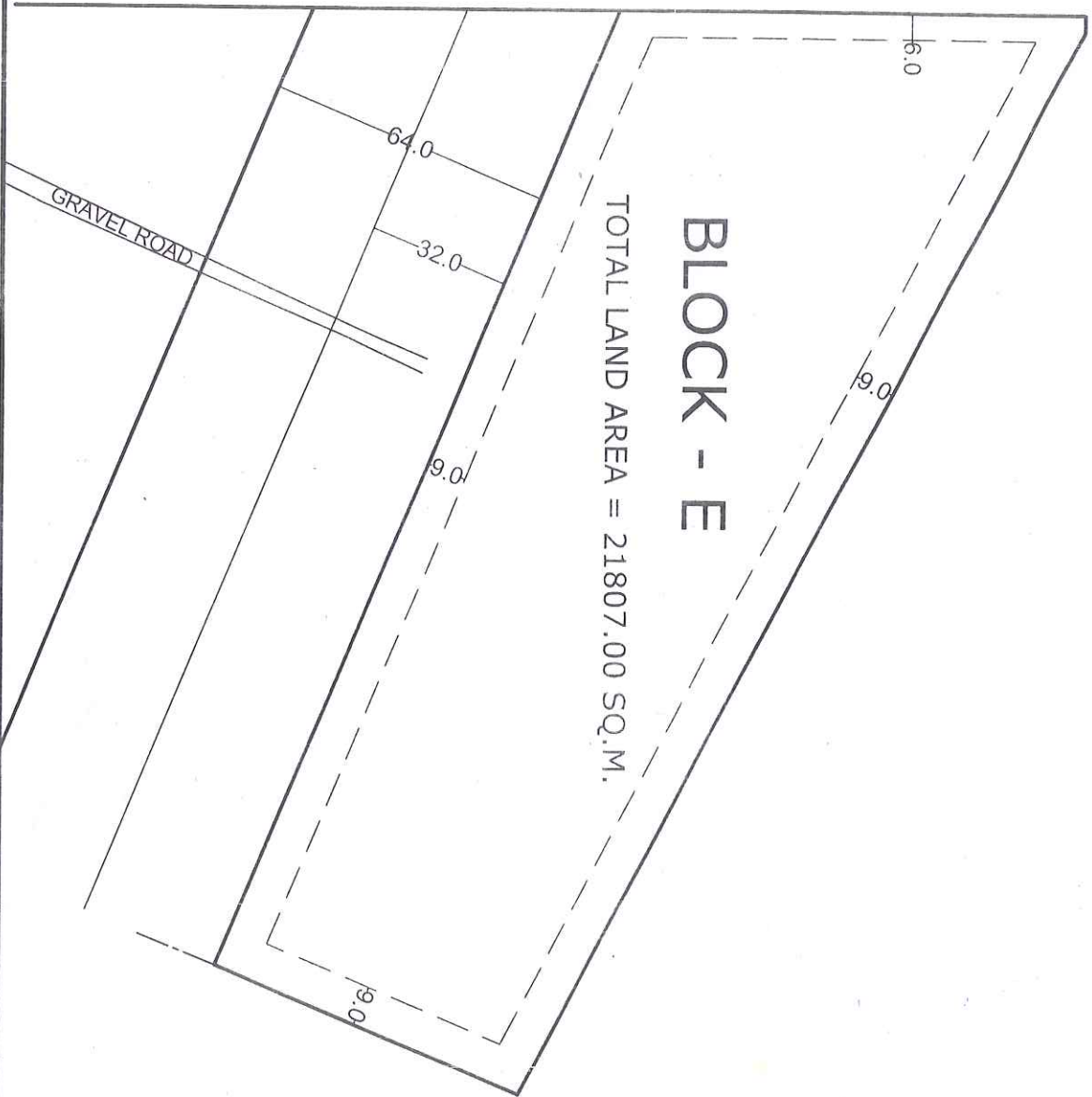

BLOCK - E
TOTAL LAND AREA = 21807.00 SQ.M.

SET BACKS :-
FRONT = 6.00 M
SIDE-I = 9.00 M
SIDE-II = 9.00 M
BACK = 9.00 M

OTHERS NORMS AS PER UNIFIED BUILDING BYE LAWS 2017

APPROVED IN 153rd P.C. MEETING DATED 8-2-2018 AGENDA NO. 8



PROPOSED PART PLAN OF GROUP HOUSING BLOCK - E (P.P. MOD) MAHLA RESIDENTIAL SCHEME JAIPUR

| DRG. NO. RRB/HQ/18/ | SCALE :- |
|---------------------------------------|---|
| DATE: 26-2-2018 | FILE NO. |
| DEPT: R.K.GUPTA | T.P.A.: SURESH KUMAR |
| (P. C. VADAV) ASSTANT TOWN PLANNER | (B.S. RAJPOURHI) DEPUTY TOWN PLANNER |
| (KIRAN JOSHI) SENIOR TOWN PLANNER | (S. SETHI) ADD. CHIEF TOWN PLANNER |

RAJASTHAN HOUSING BOARD

Google Maps

26°49'26.1"N 75°28'14.8"E

26.823925, 75.470783 PARCEL-D, MAHALA SCHEME, AJMER ROAD, JAIPUR.



Imagery ©2018 DigitalGlobe, Map data ©2018 Google

100 m

Google Maps

26°49'07.5"N 75°28'19.1"E

(26.818751, 75.471963) PARCELE-E, MAHALA SCHEME, AJMER ROAD, JAIPUR.



Google

Imagery ©2018 DigitalGlobe, Map data ©2018 Google

50 m