

PLOT NO. = 14E/L-1

ROAD 30.00 M. WIDE

TO GOPALPURA BYPASS

ROAD 30.00 M. WIDE (SHIPRA PATH)

LAND OF KASHIRAN

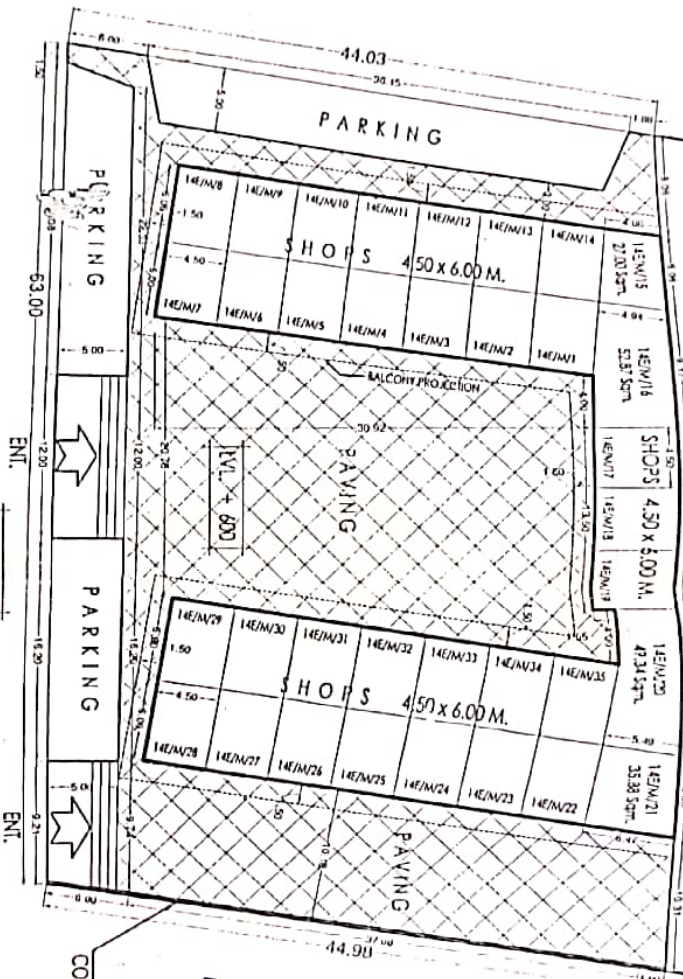

PROPOSED ROAD 18.00 M. WIDE

EXISTING COMPOUND WALL

SAMSHAN

HOUSES

HOUSES

SECTOR - 1

HOUSES

HOUSES

TO B2 BYPASS

27X18 = 486
52.87X11 = 52.87
29.34

KEY PLAN (SECTOR - 14E)



DETAIL OF PLOT :

PLOT NO. - 14E/M
PLOT AREA - 2750.00 Sqm.

S.No	Sq. Ft. No.	Area	Area in Sqm.	Use
1	14E/M/1	450.00	130.00	Shop
2	14E/M/2	450.00	130.00	Shop
3	14E/M/3	450.00	130.00	Shop
4	14E/M/4	450.00	130.00	Shop
5	14E/M/5	450.00	130.00	Shop
				TOTAL SHOPS
				5

OTHER PARKING AREAS ARE SHOWN IN THE PLAN. THIS DRAWING IS FOR INFORMATION ONLY AND IS NOT TO BE USED FOR ANY OTHER PURPOSE.



ALL DIMENSIONS ARE IN METERS
PROPOSED 2x4.50 METER (SMALL SHOPS) IN PLOT NO. 14E/M, SECTION 14E, MUNICIPALITY SCHEME JALPAI.

DATE: 20/11/2021 SCALE: 1:1000
 DRAWN: RAJESH KUMAR
 CHECKED: ANIL KUMAR
 APPROVED: RAJESH KUMAR
 RAJASTHAN HOUSING BOARD
 ADD. CHIEF TOWN PLANNER
 27/11/2021
 011/01/21