

TEPNC-234

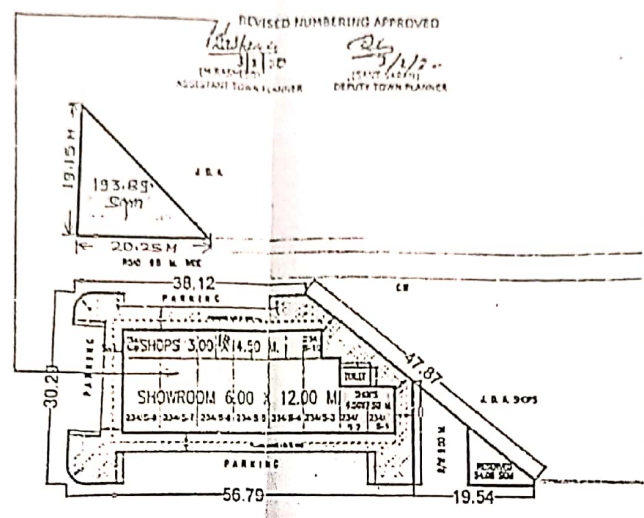

11

REVISED NUMBERING APPROVED
[Signature]
 ASSISTANT TOWN PLANNER
[Signature]
 DEPUTY TOWN PLANNER



SCHEDULE OF SHOPS

S.N.	TYPE	SIZE	NOS.
1.	SHOWROOM	6.00 X 12.00	6
2.	SHOP	4.50 X 7.50	2
3.	SHOP	3.00 X 4.50	11
TOTAL			19

RESIDENTIAL PLOT
 AREA: 317.53 SQ. MTR.

APPROVED BY 154 P.C. MEETING HELD ON
 DATED- 17-12-2019 AGENDA NO. 10



ALL DIMENSIONS ARE IN METERS

HALDI GHATI MARG 60.0 M. WIDE

TO TONK ROAD

TO MAHAL ROAD

PROPOSED C.S. PLAN AT HALDI GHATI ROAD PART LAY OUT PLAN OF SECTOR-2 PRATAP NAGAR, SANGANER JALPUR

DRG NO. 218/2019/S1	SCALE -
DATE-13.12.2019	FILE NO.
DESIGNER - E.E. GUPTA	CHECKED -
(P.C. 1544) ASSISTANT TOWN PLANNER	(TOWN PLANNER) DEPUTY TOWN PLANNER
SENDER TOWN PLANNER	(TOWN PLANNER) AND CHIEF ENGINEER

RAJASTHAN HOUSING BOARD