

Proposed Mandalnath Scheme at Kh. no. 93/10, Village Paldi Khichiyan Jodhpur -

To Kaliberi

To Mandore

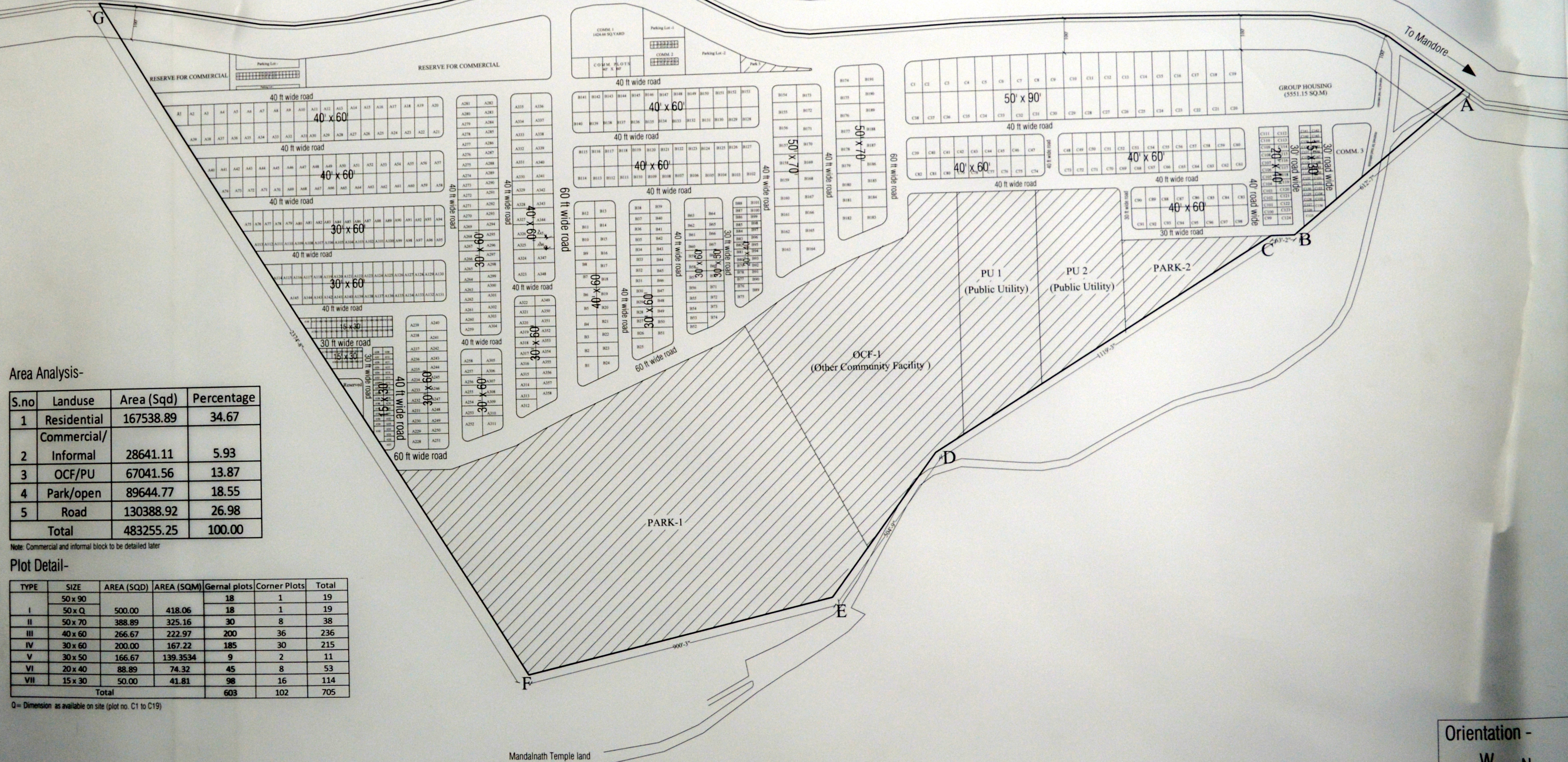

Area Analysis-

S.no	Landuse	Area (Sqd)	Percentage
1	Residential	167538.89	34.67
2	Commercial/ Informal	28641.11	5.93
3	OCF/PU	67041.56	13.87
4	Park/open	89644.77	18.55
5	Road	130388.92	26.98
Total		483255.25	100.00

Note: Commercial and informal block to be detailed later

Plot Detail-

TYPE	SIZE	AREA (SQD)	AREA (SQM)	Genral plots	Corner Plots	Total
I	50 x 90			18	1	19
	50 x Q	500.00	418.06	18	1	19
II	50 x 70	388.89	325.16	30	8	38
III	40 x 60	266.67	222.97	200	36	236
IV	30 x 60	200.00	167.22	185	30	215
V	30 x 50	166.67	139.3534	9	2	11
VI	20 x 40	88.89	74.32	45	8	53
VII	15 x 30	50.00	41.81	98	16	114
Total				603	102	705

Q= Dimension as available on site (plot no. C1 to C19)

Note: This drawing is prepared after demarcation of blocks and requisite changes of approved plan dated: 03.07.15

Orientation -



Scale : 1" = 100'

Approval signatures and stamps from various authorities:

- Junior Engineer, JODHPUR DEVELOPMENT AUTHORITY
- Town Planning Assistant, JODHPUR DEVELOPMENT AUTHORITY
- Assistant Engineer, JODHPUR DEVELOPMENT AUTHORITY
- Assistant Town Planner, JODHPUR DEVELOPMENT AUTHORITY
- Tehsildar, JODHPUR DEVELOPMENT AUTHORITY
- Executive Engineer, JODHPUR DEVELOPMENT AUTHORITY
- Deputy Town Planner, JODHPUR DEVELOPMENT AUTHORITY
- Deputy Commissioner, JODHPUR DEVELOPMENT AUTHORITY
- Director (ENGINEERING), JODHPUR DEVELOPMENT AUTHORITY
- Director (PLANNING), JODHPUR DEVELOPMENT AUTHORITY
- Secretary, JODHPUR DEVELOPMENT AUTHORITY
- Commissioner, JODHPUR DEVELOPMENT AUTHORITY

Drawn by: Sarath
 Date: 10.09.2015