

SIDHI VINAYAK - VIHAR

PROPOSED RESIDENTIAL SCHEME ON KHASRA NO.129/1, 142, 142/1, 142/2, 142/3, 143, 143/3 & 143/4. OF VILLAGE PAL NEAR SHARA - INDIA ON BARMER ROAD AT JODHPUR.

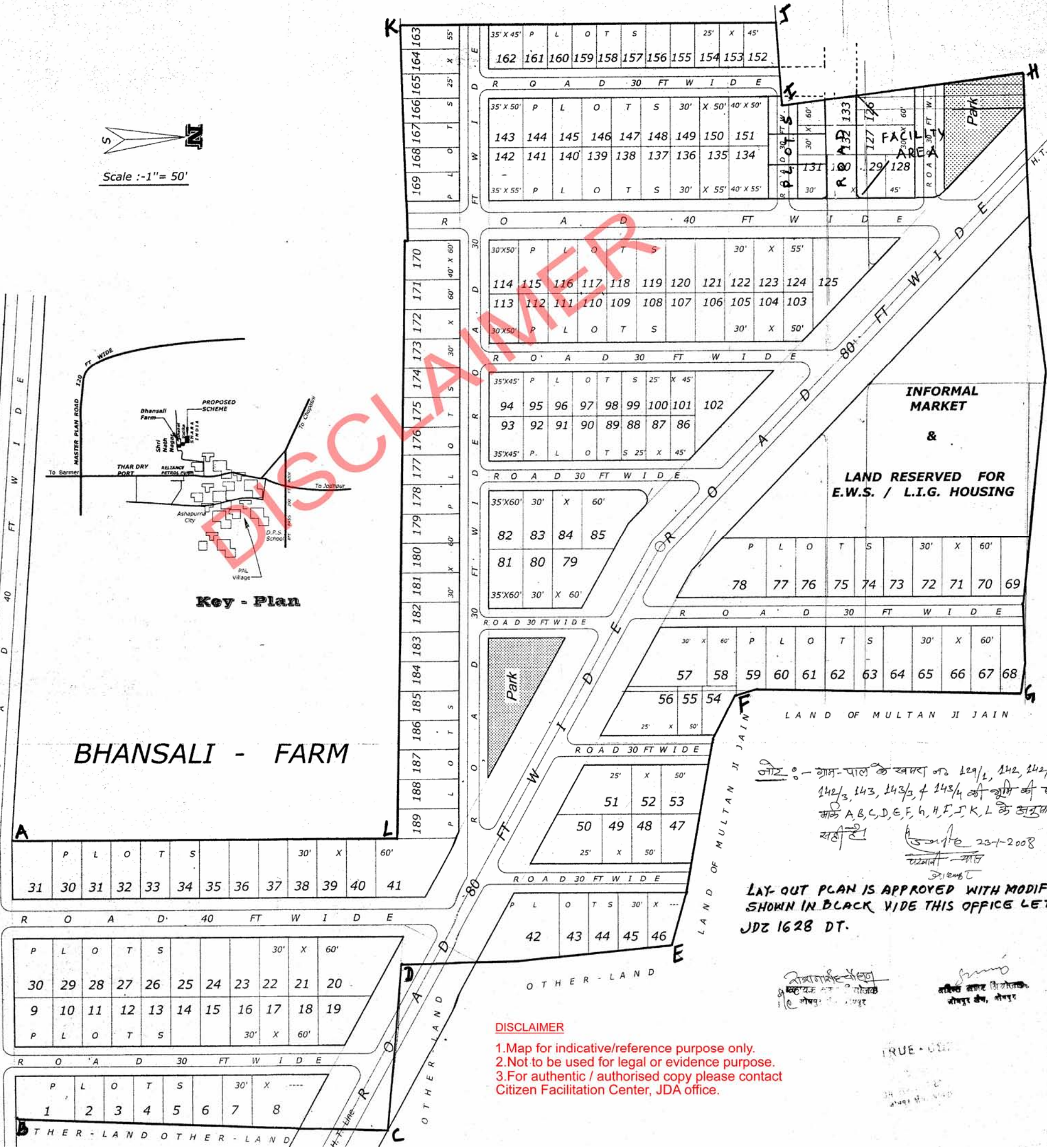
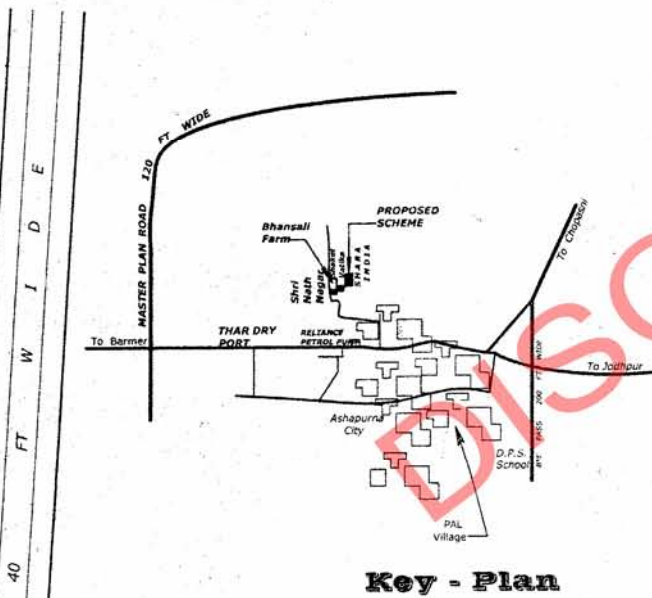
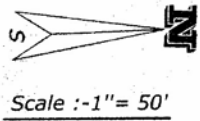

गोटे :- ग्राम-पाल के खसरा नं. 129/1, 142, 142/2, 142/3, 143, 143/3, 143/4 की जमीन की संपादन आक A, B, C, D, E, F, G, H, I, K, L के अनुसार सौभाग्य सही है।
 दिनांक 23-1-2008
 जयसिंह
 जयसिंह

LAY-OUT PLAN IS APPROVED WITH MODIFICATION SHOWN IN BLACK VIDE THIS OFFICE LETTER JDZ 1628 DT.

DISCLAIMER
 1. Map for indicative/reference purpose only.
 2. Not to be used for legal or evidence purpose.
 3. For authentic / authorised copy please contact Citizen Facilitation Center, JDA office.

जयसिंह
 जयसिंह
 जयसिंह

TRUE COPY

SHRI NATH - NAGAR

SHARA - INDIA