

PROPOSED RESIDENTIAL SCHEME ON KHASRA NO. 561
 OF VILLAGE DHENANA KI DHANI (PAL) NEAR PAL
 SANGARIYA ROAD AT JODHPUR

AREA ANALYSIS

S.NO	PARTICU	SQ.YDS.	%
1	PLOT	7602.13	59.95
2	ROAD	4504.22	35.51
3	O.C.F.	574.44	4.53
4	TOTAL	12680.8	100

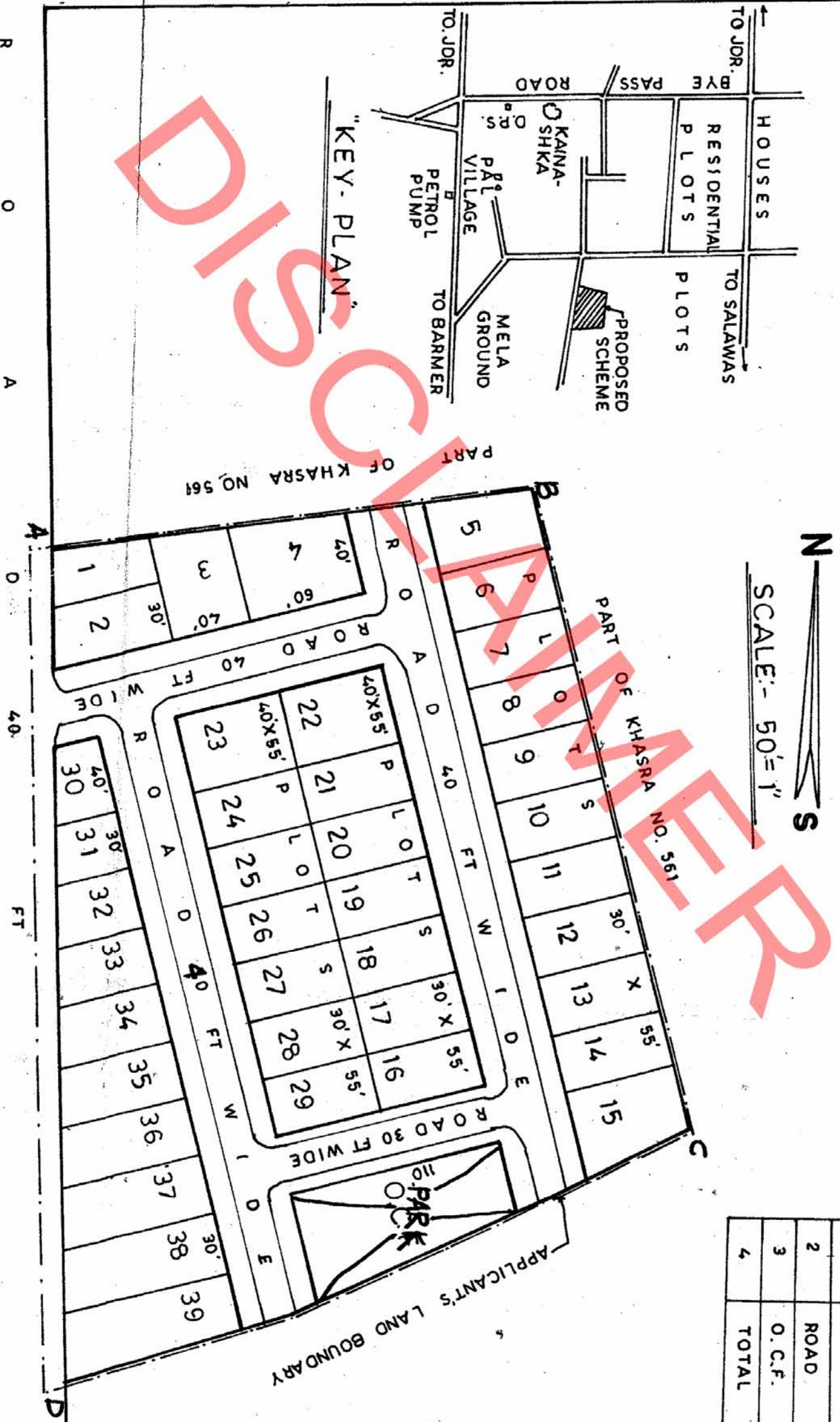

SITE ABCD APPROVED AS AMENDED. **DISCLAIMER**

20/11/2016
 2-1-66
 2-1-66

1. Map for indicative/reference purpose only.
2. Not to be used for legal or evidence purpose.
3. For authentic / authorised copy please contact Citizen Facilitation Center, JDA office.

WASHALI CITY EXT.

SANGARIYA

MAIN

SANGARIYA

PAL

ROAD

100

FT

WIDE

TO PAL